

UL - MODULAR PLAY SYSTEMS

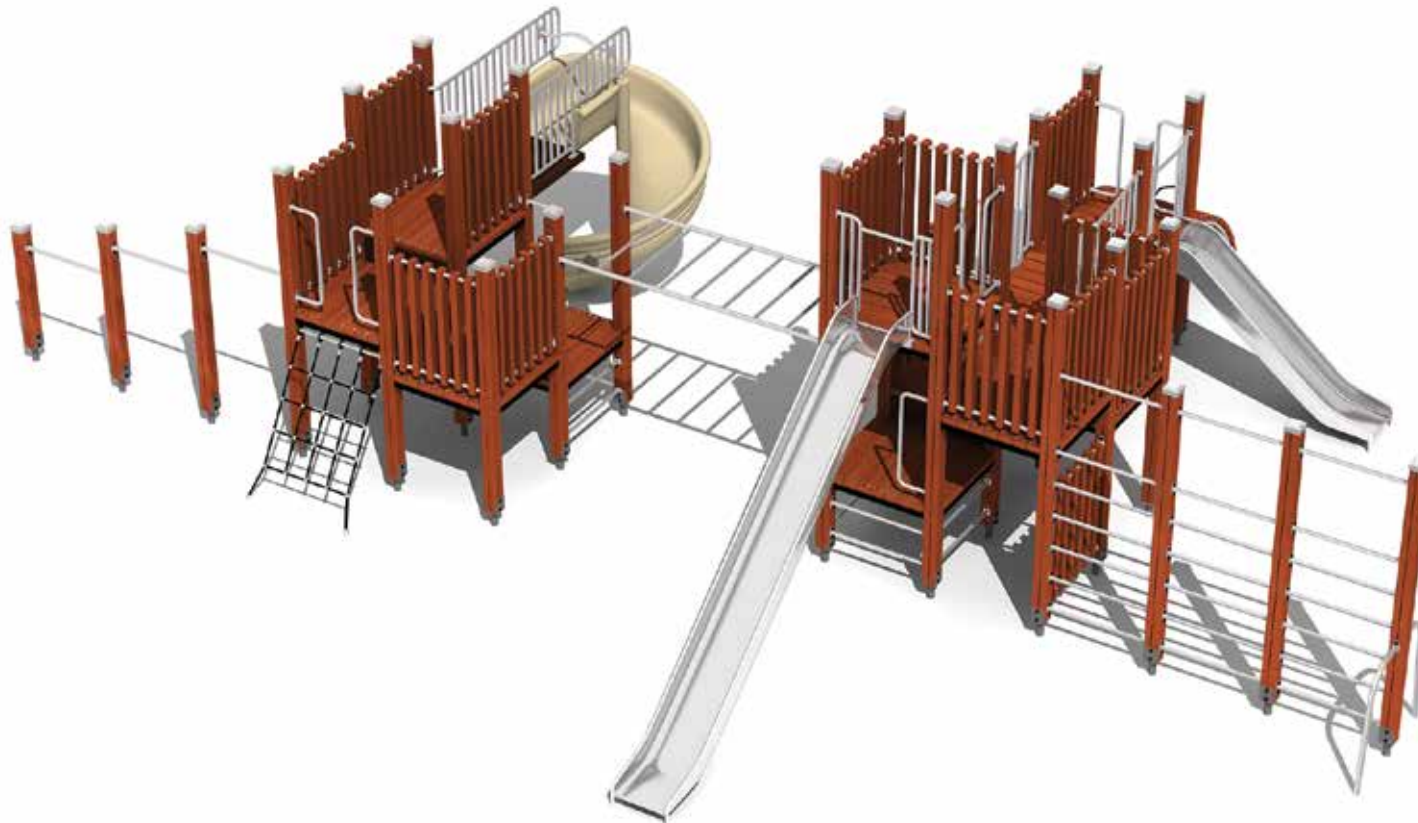

Model Name: **UL-US603**



Soft Fall Area 12972

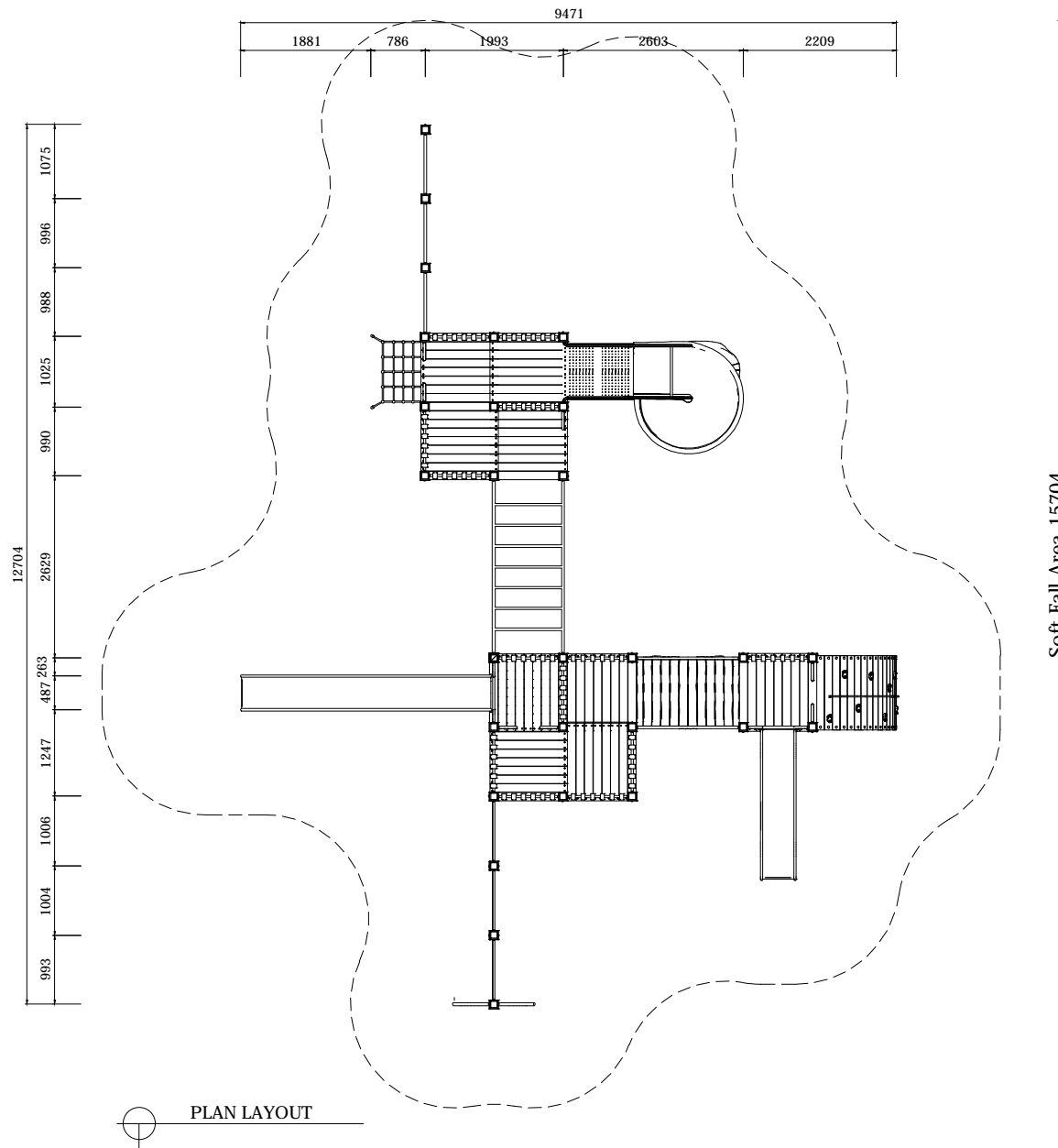

PLAN LAYOUT

Soft Fall Area 15704

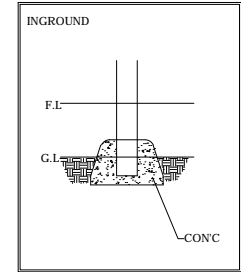

Scale : NTS

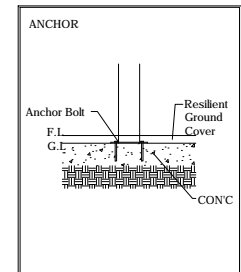

Scale : NTS

TYPICAL FOOTING DETAILS

Specification

Product Category : Ultra Stainless Play Systems

Model Name : UL-US603

Standards: AS4685 Parts1-6 & 11 - 2014

Scale: 1:100 @ A4

Summary:

- Play structure size : 12.7m x 9.5m
- Approx. soft fall area : 126.1m²
- Approx. soft fall size : 15.7m x 13.0m
- Accommodates : 35 to 40 children
- Overall height : 3.8m
- Free height of fall : 2.7m



CRS Creative Recreation Solutions PTY LTD
 Address: Unit 1/25 Durgadin Drive Albion Park Rail NSW 2527
 Phone: (02) 4256 2991 Fax: (02) 4256 3991 E-mail: info@crs.net.au Web: www.crs.net.au

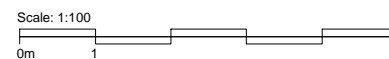

- Note:
- DO NOT mirror, reverse or reflect this design
 - DO NOT scale in any way

If in doubt ask one of our friendly staff:
 Phone: (02) 4256 2991 E-mail: info@crs.net.au



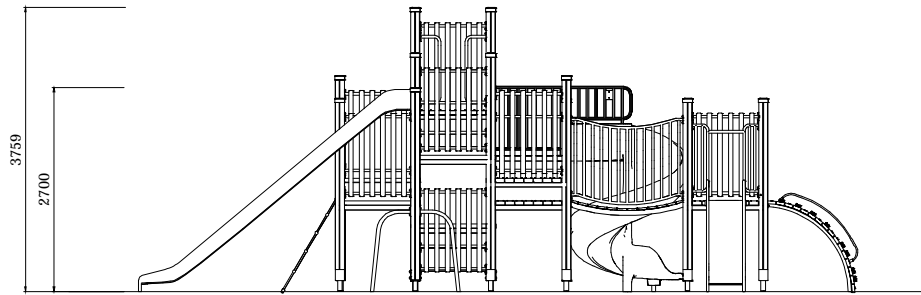

ELEVATION - FRONT

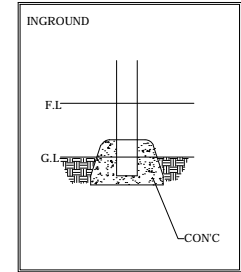

Scale : NTS

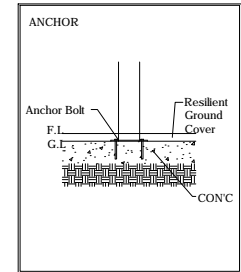

Scale : NTS

TYPICAL FOOTING DETAILS

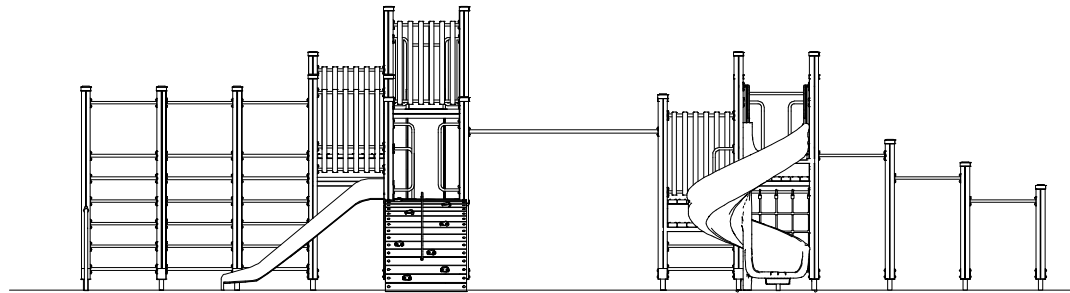

ELEVATION - RIGHT

Specification
Product Category : Ultra Stainless Play Systems
Model Name : UL-US603
Standards: AS4685 Parts1-6 & 11 - 2014
Scale: 1:100 @ A4
Summary: <ul style="list-style-type: none"> • Play structure size : 12.7m x 9.5m • Approx. soft fall area : 126.1m² • Approx. soft fall size : 15.7m x 13.0m • Accommodates : 35 to 40 children • Overall height : 3.8m • Free height of fall : 2.7m

